

*View of Gibbs Station and
Marquam Hill Connector
Conceptual rendering subject to change*



SOUTHWEST CORRIDOR LIGHT RAIL PROJECT

CONNECTING MARQUAM HILL TO MAX

Marquam Hill is home to Oregon Health & Science University (OHSU), Veterans Administration of Portland, the Shriners Hospital, residences and supporting businesses, and attracts over 18,000 employees, patients, students and residents each day from all around the region. The Southwest Corridor Light Rail Project will include a connection from the new MAX station at Barbur Boulevard and Gibbs Street to Marquam Hill. This short distance up the steep hill requires a safe, accessible connector to help move people from the station to Marquam Hill destinations.



Marquam Hill attracts over 18,000 employees, patients, students and residents each day from all around the region



The new connection is projected to serve 10,000 trips each weekday by the year 2035



Inclined elevators will provide convenient access up the 100+ foot elevation gain between the MAX station and Marquam Hill



This connection will serve people riding the new light rail line, people utilizing bus service on the shared transitway on Barbur Boulevard and people riding on bus lines that run down Naito Parkway. It will also be a convenient connection for cyclists riding along the future Barbur streetscape improvements, as well as people living in the South Portland neighborhood. It will align with the Darlene Hooley Pedestrian Bridge along Gibbs Street to provide a walking route between Marquam Hill and the South Waterfront to supplement the Portland Aerial Tram overhead. By 2035, this new connection is expected to serve 10,000 trips per day from riders on both the new MAX line and bus routes, making it safer and easier for people to travel between the Gibbs Street Station and Marquam Hill.

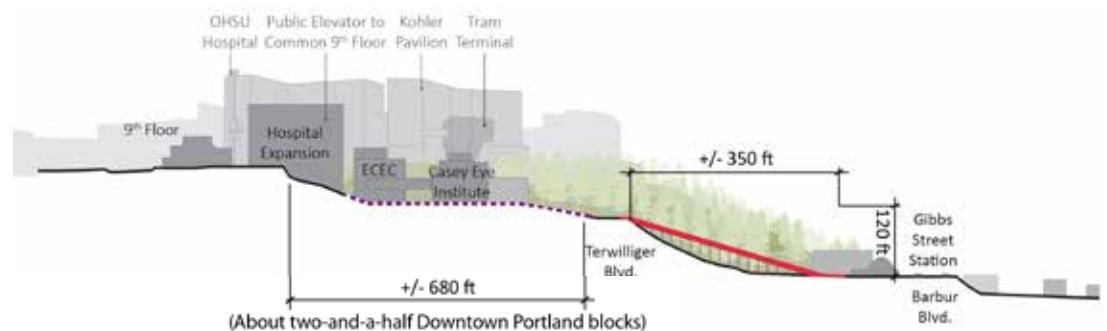

Cross-section

The distance between Terwilliger Blvd. and the OHSU Hospital Expansion is +/- 680 feet—the equivalent of two-and-a-half Downtown Portland blocks.

WHY THE MARQUAM HILL CONNECTOR?

Compared with existing bus service to Marquam Hill, a mechanical connection between the Gibbs Station and Terwilliger Parkway will improve travel times to Marquam Hill destinations from both the north and the south, have lower operating costs and CO2 emissions, and will provide capacity for thousands of additional daily riders.

CHOOSING THE RIGHT CONNECTOR: INCLINED ELEVATOR

An inclined elevator has been selected as the preferred connector choice. Choosing the right connector involved multiple phases of robust public engagement and technical review, including analyzing the effects on Terwilliger Parkway – a historic park resource with Federal, state and local mitigation requirements.

- From February 2019 to June 2019, a Green Ribbon Committee comprised of design experts and public and private leaders led a public involvement process that resulted in a strong recommendation of an inclined elevator to the project Steering Committee.
- In June 2019, the Steering Committee suggested further study of both the inclined elevator and the bridge and elevator options.
- During the February and March 2020 SW Corridor Conceptual Design open houses, the inclined elevator received substantially higher ratings than the bridge and elevator option.
- Through consultations with Portland Parks & Recreation during Spring 2020, the inclined elevator was determined to have the least harm to Terwilliger Parkway compared to other options.

The inclined elevator option meets project design criteria of being safe, accessible, efficient and sensitive to Terwilliger Parkway's historic context and natural resources, and affordable to build and maintain.

HOW WILL IT WORK?

An inclined elevator works similar to a standard elevator but provides horizontal and vertical movement. Inclined elevators resemble historic funiculars, found throughout Europe, the US, and Canada, but use modern technology. A contemporary example can be found in Edmonton, Canada.

Two elevator cabs, each with a capacity of 25 people, will run on parallel tracks to efficiently move people up the steep slope toward Marquam Hill. A trip in the elevator will take about 60 seconds.

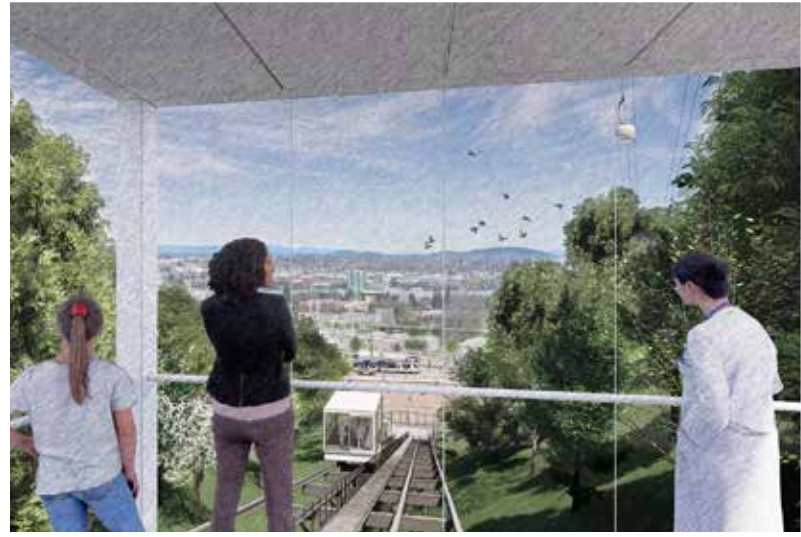

View from Interior

A trip in an inclined elevator will take approximately one minute. Conceptual rendering subject to change.



From the top of the inclined elevator, at Terwilliger Parkway and Campus Drive, an accessible pathway will connect to elevators within the OHSU campus.

Riders will also be able to access Line 8-Jackson Park/NE 15th Ave here, which provides frequent, door-to-door service to many Marquam Hill destinations.

View from Terwilliger Parkway

View from Campus Drive. Conceptual rendering subject to change.

WHAT'S NEXT?

Ongoing design of the inclined elevator will require close coordination between Marquam Hill stakeholders including OHSU, Portland Parks, Friends of Terwilliger and the neighboring community. The Marquam Hill Connector would be constructed as part of the larger light rail project between 2023 and 2026, with operations beginning in 2027.

For more information, visit trimet.org/swcorridor or call **503-962-2150**.

**+400,000
PEOPLE**

**+260,000
JOBS**

in the region
by 2040

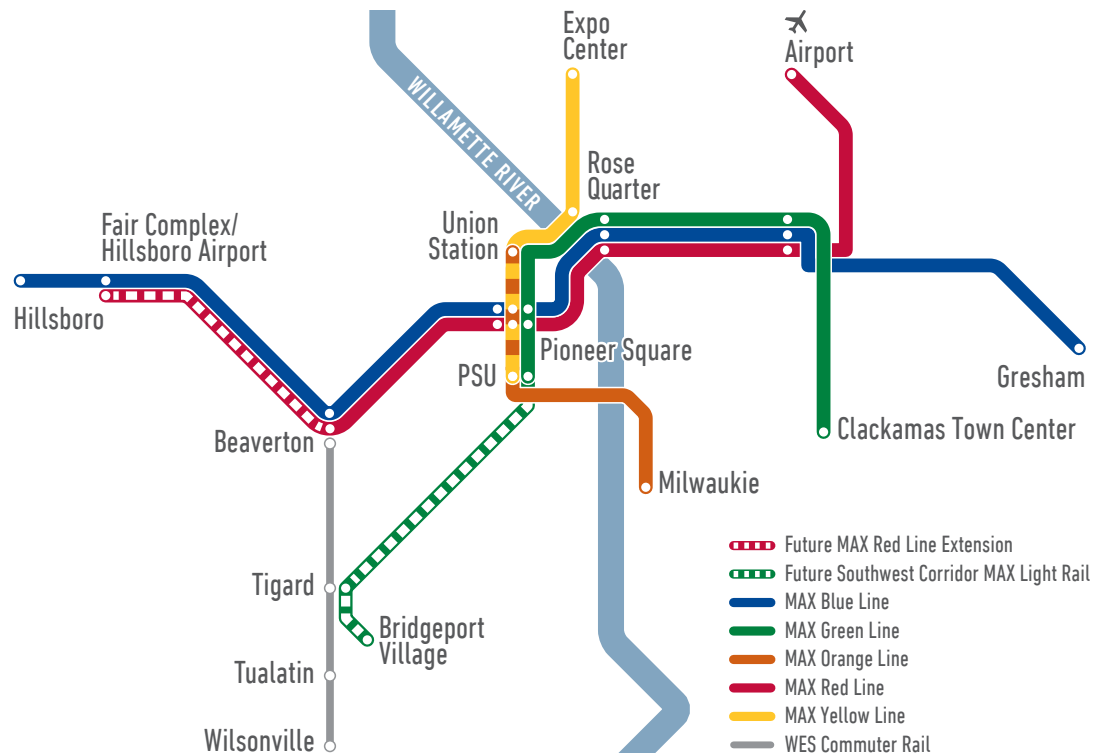

PROJECT PARTNERS



For language assistance call
Si necesita interprete, llame al
Nếu cần trợ giúp về thông dịch xin gọi
如需语言帮助请致电
Для службы языковой поддержки
언어 통역이 필요하시면, 으로 전화 하시면 됩니다

503-238-7433

